

30 March 2021

Dear Parents/Carers

### **Summary of Changes Proposed for September 2021 For Parents/Carers - March 2021**

Further to the parent/carer meeting on Wednesday 3 March 2021, below is an outline of the changes proposed for September 2021. The changes build on our curriculum development over recent years, combined with new routines which have arisen through the last twelve months of disruption. The model also provides a useful structure for us to support and prepare students who will be approaching their GCSE and A Level examinations next year.

St Katherine's continues to grow and we are delighted to be oversubscribed for places in September 2021. The school will be accommodating almost 1000 students and some of the structural changes will continue to support the smooth running of the school day.

Please take time to understand the proposed changes by watching the recording of the meeting below which talks through the presentation and provides context for the changes for September 2021. We would be grateful if you could share your feedback using our form which reflects each of the changes in turn.

[Presentation from meeting](#)

[Recording of meeting](#)

[Q&A document](#)

[Feedback form](#)

Thank you for taking the time to read through the changes and for taking the time to share your feedback. Once all feedback has been carefully considered, we will make a decision and communicate this with the whole community in Term 5.

Kind regards



Justin Humphreys  
Headteacher

## Context (1.11 to 6.01 on video)

Learning together, succeeding together, inspiring excellence

**Context**

During the academic year 2018/19 and 2019/20

- explored a new curriculum with enrichment for Year 7 and Year 8
- New school day as a result of COVID 19
- New bus service for over 400 students
- More than 970 students in September 2021

Positive and negative impact  
Term 1 and Term 2 reflections / historic challenges

School day = rhythm of daily life in school

RESPECT | RESILIENCE | RESPONSIBILITY

Learning together, succeeding together, inspiring excellence

**What are we trying to achieve?**

The school day runs smoothly for all  
Rhythm to the week/fortnight  
Delivery of an ambitious curriculum for all students  
Quality educational experience for all students

*First choice school for families, High levels of achievement, Resilient attitudes, Health mind, body, spirit and individual character*

RESPECT | RESILIENCE | RESPONSIBILITY

## Proposed changes

- **School day start time - 8:35am, finish time 3:00pm (minute 6.20 to 8.56 on video)**
  - Note the changes to the school day - start time, late finish every Monday, early finish each Week 2 Wednesday
  - Buses to arrive between 8:15 and 8:25
  - Continue with our dynamic routing working with Turners to reduce the average travelling time for all students
  - On Mondays, buses will leave at 16:00
  - On Week 2 Wednesdays, buses will leave at 14:00pm

WEEK ONE Monday - Friday WEEK TWO Monday, Tuesday & Thursday, Friday	
Time	Activity
8.35 - 9.00	Tutor Time and DEAR
9.00-10.00	Period 1
10.00-11.00	Period 2
11.00-11.20	Break
11.20-12.20	Period 3
12.20-12.55	First Lunch
12.55-13.55	Period 4
12.20-13.20	Period 4
13.20-13.55	Second Lunch
13.55-14.50	Period 5
14.50-15.00 Tues-Fri	Staggered Departure
MONDAYS 14.50-15.50 15.50-16.00	Enrichment Staggered Departure

WEEK TWO WEDNESDAY	
Time	Activity
8.35-9.35	Period 1
9.35-9.55	Break
9.55-10.55	Period 2
10.55-11.55	Period 3
11.55-12.25	First Lunch
12.25-13.20	Period 4
11.55-12.50	Period 4
12.50-13.20	Second Lunch
13.20-13.45	Tutor Time and DEAR
13.45-13.55	Staggered Departure
13.55-14.05	Break
14.05-15.00	CPL Training Session

- **Enrichment for all on Mondays / school end time - 4pm (minute 8.56 to 13.25 on video)**
  - SKYwards - St Katherine's Youth Award was due to be launched 12 months ago. This will now launch at the start of the 2021/22 academic year. More information to follow during the summer term.
  - SKYwards will recognise and celebrate involvement in the full range of the enrichment programme, careers activities and personal development.
  - All students will be provided with a UNIFROG account which will be used to track and reflect upon their progress.
  - Awards will be made annually at the House Celebration Evenings with the expectation that all students should be able to achieve bronze in Year 7, silver in Year 8, gold in Year 9 and Platinum in Year 10.

## Monday Enrichment for all students

Year	
7	Each term, students complete an enrichment opportunity under a different theme. For example: Sport, STEAM, Performing Arts, Communication, Language, Leadership/Team skills
8	
9	
10	1 x sport session each fortnight. 1 x learning skills (and the opportunity to practise) each fortnight.
11	Based on individual needs, students will either complete independent study or subject intervention
Post 16	Develop a model of 'giving back' to develop skills and leadership We are looking to grow the 6th form electives programme through a separate timetabled period

Linked to the development of SKYwards - St Katherine's Youth Award

- **Continuous Professional Learning for staff / school finish time - 2pm (minute 13.35 to 14.31 on video)**
  - In balancing staff time and wellbeing alongside enrichment, we have integrated continuous professional learning with a focus on effective classroom delivery for all teaching staff
  - Training options for all staff will be available
- **Split lunchtime (minute 16.30 to 19.24 on video)**
  - Split lunchtimes to allow our canteen and foodpod to cater for all students (970) with shorter queuing times for all students and improved access to our canteen
  - For example, the split could be Year 7,8 & 9 on first lunch with Year 10 and Year 11 on second lunch, with the sixth form attached or with a flexible model to suit their timetable for the day
  - More reasonable lunchtimes for students
  - A full range and quantity of food will be available for all students
  - See full school day under 1) above

12.20-12.55	First Lunch
12.55-13.55	Period 4
12.20-13.20	Period 4
13.20-13.55	Second Lunch

- **Staggered exits (minute 19.25 to 20.27 on video)**
  - Staggered exit over ten minutes each day to allow all students to leave school in a safe and orderly manner, starting with Year 7 and ending with Year 13
  - See school day timeline under 1)
- **After school detentions on Tuesday and Thursday for one hour (minute 20.45 to 22.45 on video)**
  - A structure to help students improve their approach to school and conduct in school
  - An additional layer between Ready To Learn and fixed term exclusions (where appropriate)
  - To provide individual reflection time and intervention to support students
  - Support will be provided for students to get home
- **House Homes (minute 14.50 to 16.21 on video)**
  - To create 'homes' for each of our houses and to allow Heads of House to greet their students each morning as they enter their house

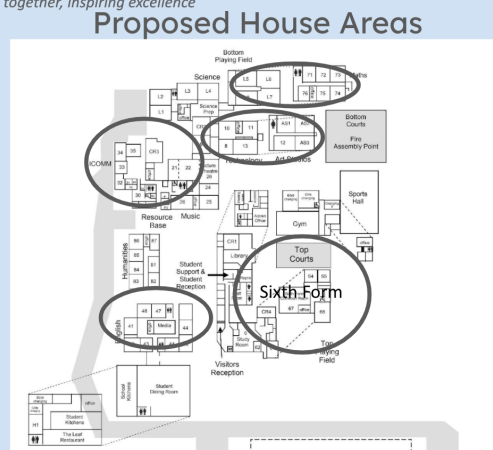

## ● Uniform (minute 22.50 to 28.25 on video)

Learning together, succeeding together, inspiring excellence

### Change to standard uniform skirts/trousers

Why?

- To drive up standards of uniform throughout the school.
- To avoid any confusion over what is/is not acceptable school uniform.
- Inconsistencies in uniform currently (now beginning to highlight those students whom we purchase uniform for).

RESPECT | RESILIENCE | RESPONSIBILITY

Learning together, succeeding together, inspiring excellence

### Proposed roll out

Current Yr7 and Yr8 pupils will be supplied with either a skirt or pair of trousers.

Current Yr9 and Yr10 pupils will not be affected by the uniform change.

All students in receipt of the Pupil Premium will receive a discount of 10% on uniform if purchased through the school as well as a £40 voucher for uniform.

All families are able to access support through the St Katherine's hardship fund.

Please send comments and questions to [mawm@skdrive.org](mailto:mawm@skdrive.org)

RESPECT | RESILIENCE | RESPONSIBILITY

Learning together, succeeding together, inspiring excellence

### Options

A - grey skirt with checked pleats  
 B - grey/maroon kilt  
 C - maroon/navy kilt



RESPECT | RESILIENCE | RESPONSIBILITY

Learning together, succeeding together, inspiring excellence



RESPECT | RESILIENCE | RESPONSIBILITY

	Child sizes (KS3)		
	Previous Supplier Cost	New Supplier Cost	With Pupil Premium discount
<b>Blazer (28" - 32")</b>	£32.50	£33.50	£30.15
<b>Trousers</b>	From £17.50	£18.75	£16.88
<b>Skirt</b>	From £18.50	£18.75	£16.88
<b>Jumper (30-32")</b>	£18.50	£16.50	£14.85
<b>Tie</b>	£5	£5	£4.50

	Adult sizes (KS4)		
	Previous Supplier Cost	New Supplier Cost	With Pupil Premium discount
<b>Blazer (34"-36")</b>	£36.50	£38.50	£34.65
<b>Trousers</b>	From £17.50	£18.75	£16.88
<b>Skirt</b>	From £18.50	£18.75	£16.88
<b>Jumper (34"-38")</b>	£20.50 - £22	£20.75	£18.68
<b>Tie</b>	£5	£5	£4.50

We will be changing our uniform skirts and trousers for September for children in KS3 (Years 7, 8 and 9). The new provider, [Monkhouse](#), is more accessible with shops in and around Bristol. In order to support families with this change, we will be supplying a pair of trousers or skirt to all children who will be in Years 8 and 9 in September 2021 in recognition of the fact that families will have already spent money to purchase their uniform. From September 2021, we expect all Key Stage 3 pupils to be wearing the new uniform skirt or trousers.

We intend to operate a second-hand uniform shop via the Student Support Office (SSO). You will be able to return any uniform that your child has outgrown and receive 50% of the cost of that item in return - this will be in the form of a credit note to be redeemed at the supplier when purchasing uniform. The items returned to school will need to be in good, reusable condition. This means no tears, stains or other damage. If you wish to purchase second-hand uniform via the SSO, this will be at the discounted rate of 50%, depending on availability.

Our blazers are a new-style and of higher quality than previously. We will run down existing stock before supplying the new blazer to children. There is no expectation that families update their blazers until they are outgrown or otherwise no longer suitable for school. Jumpers remain almost identical in style. Again, there is no expectation that families replace existing jumpers. Ties also remain the same and are made from recycled materials.

Any student in receipt of the Pupil Premium can request additional funding up to £40 towards the cost of uniform. They will also receive a 10% discount on uniform at the point of purchase. Any family for whom uniform costs present a financial challenge can request support via our St Katherine's Hardship Fund.